

## GARDEN LED LIGHT

**E293** WITH SPIKE

Please read instructions before commencing installation and retain for future reference.

### SPECIFICATIONS

- **Material:** Aluminum - ABS
- **Lamp type:** LED , 5.5W , 3000K , 629Lm , CRI 92
- **Ingress Protection:** IP65. Protection against entry of solid objects greater than 12mm in diameter.

### INSTALLATION INSTRUCTIONS

**⚠** Electrical products can cause death, injury, or damage to property. Maintenance and installation should only be carried out by a professional electrician.

**⚠** The light source contained in this luminaire shall only be replaced by the manufacturer or his service agent or a similar qualified person.

- Ensure main supply is switched off.

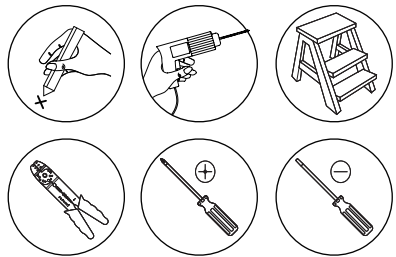

### WARNING

- Make sure that the products is installed properly before connecting to electricity.
- Do not cover the fitting.

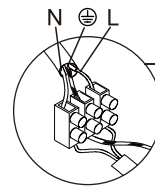
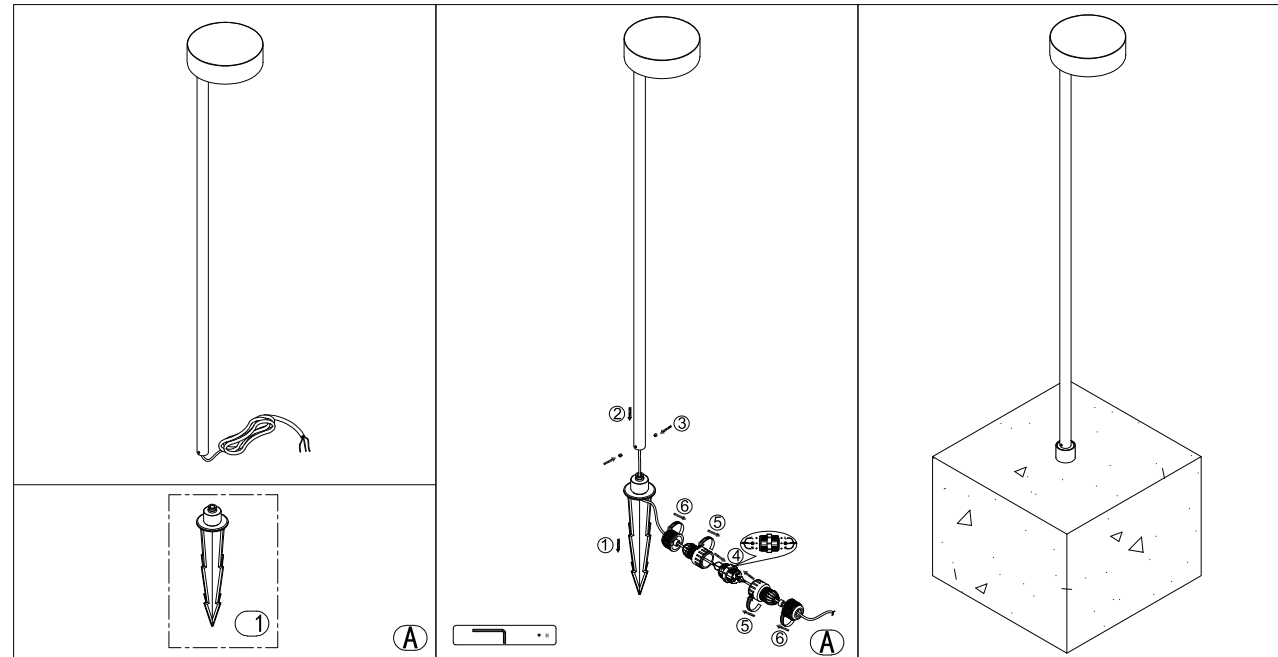

#### Connecting the Terminal Block

Connect main supply (**brown - Live, blue - Neutral**) into terminal block making sure all connections are tight.

## GARDEN LED LIGHT

**E293** WITH BASE

Please read instructions before commencing installation and retain for future reference.

### SPECIFICATIONS

- **Material:** Aluminum - ABS
- **Lamp type:** LED , 5.5W , 3000K , 629Lm , CRI 92
- **Ingress Protection:** IP65. Protection against entry of solid objects greater than 12mm in diameter.

### INSTALLATION INSTRUCTIONS

**!** Electrical products can cause death, injury, or damage to property. Maintenance and installation should only be carried out by a professional electrician.

**!** The light source contained in this luminaire shall only be replaced by the manufacturer or his service agent or a similar qualified person.

- Ensure main supply is switched off.

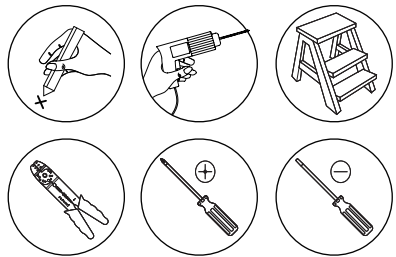

### WARNING

- Make sure that the products is installed properly before connecting to electricity.
- Do not cover the fitting.

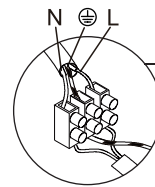
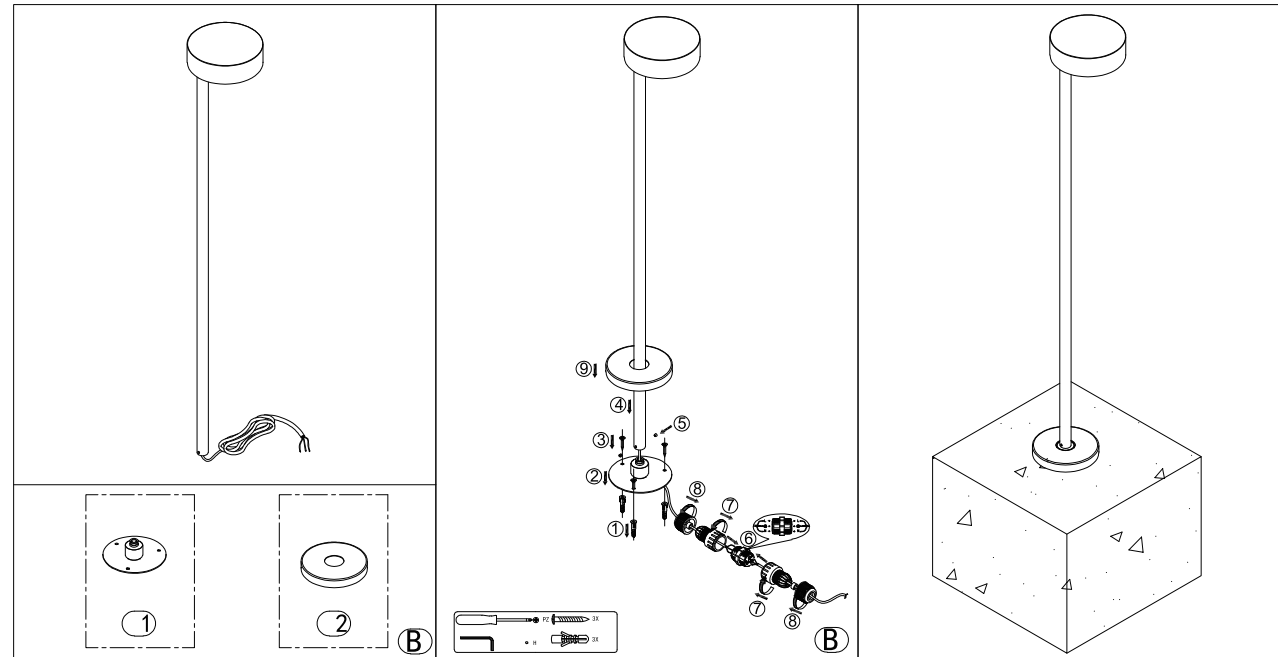

### Connecting the Terminal Block

Connect main supply (**brown - Live**, **blue - Neutral**) into terminal block making sure all connections are tight.