

Connecting the Terminal Block

Connect main supply (brown - Live, blue - Neutral) into terminal block making sure all connections are tight.

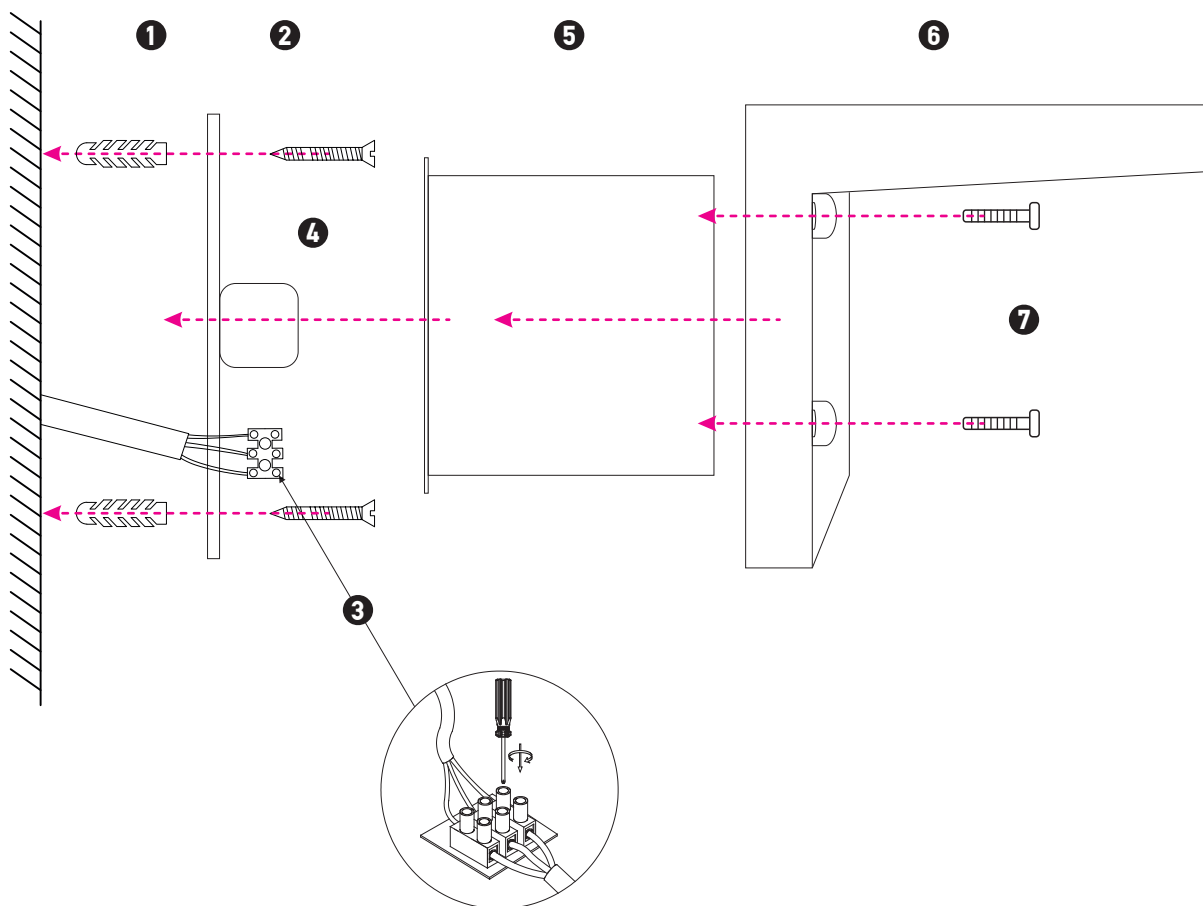

OUTDOOR WALL LIGHT

E128

Please read instructions before commencing installation and retain for future reference.

SPECIFICATIONS

- **Material:** Aluminum | PC Diffuser
- **Lamp Type:** E27 | 18W MAX
- **Ingress Protection:** IP54 Protection against entry of solid objects greater than 12mm in diameter.

INSTALLATION INSTRUCTIONS

! Electrical products can cause death, injury, or property damage. Maintenance and installation should only be carried out by a professional electrician.

- Ensure the main supply is switched off.
- Remove the outer surface of the fixture from the main body.
- Insert wall anchors into the mounting surface (1).
- Fit the mounting bracket onto the mounting surface with self-tapping screws (2).
- Connect main supply wires to terminal block (3) making sure all connections are tight.
- Add an E27 bulb to the lamp holder (4).
- Move the PC Diffuser through the main body and hold both onto the wall bracket (5-6).
- Secure them onto the mounting surface with the screws (7).
- Reconnect power.

WARNING

! Make sure that the products are installed properly before connecting to electricity. Do not cover the luminaire. Do not exceed the maximum wattage rating of the lamp. If the light source is contained in this luminaire (integrated LED), it shall only be replaced by the manufacturer, his service agent, or a similarly qualified person.

